

Meeting and Event Capacities



Room & Dimensions	Square Feet	Ceiling Height	U-Shape	Hollow Square	Conference	Classroom	Theatre	Crescent Rounds 6 PPL	Reception	Banquet Rounds		
										60"	66"	72"
Albemarle Room 29' x 26'	754	10'	24	28	24	27	50	30	70	40	—	50
Arbor Room 39' x 32'	1248	9' 3"	20	—	22	40	75	36	80	48	—	60
Original Ballroom 91' x 38'	3458	11' 1"	72	82	68	220	300	132	350	192	—	220
Blue Ridge Room 32' x 21'	672	10'	18	16	18	24	50	30	50	40	—	50
Coach Room 30' x 24'	720	8'	15	16	18	16	25	18	40	16	—	20
Commonwealth Room 29' x 26'	754	10'	24	28	24	27	50	30	60	40	—	50
Ednam Hall 61' x 30'	1830	9' 3"	42	48	40	66	120	60	150	80	—	100
Ednam East Side	915	9' 3"	15	18	18	24	60	24	50	32	—	40
Ednam West Side	915	9' 3"	15	18	18	24	60	24	50	32	—	40
Hearth Room 50' x 45'	2250	10' 4"	25	28	30	—	96	72	150	96	—	120
Patio Room 45' x 22'	990	9' 3"	14	—	16	42	77	36	75	48	—	60
Tack Room 32' x 17'	544	8' 3"	17	16	22	20	42	18	40	24	—	30
Special Purpose Suite 24' x 13'	312	8' 10"	—	—	—	—	10	—	10	—	—	—
Grand Ballroom 111' x 53'	5883	19'	125	125	—	378	630	270	600	—	450	—
Pavilion I 54' x 36'	1944	19'	47	48	38	123	200	84	189	—	150	—
Pavilion II 54' x 36'	1944	19'	47	48	38	126	205	84	195	—	150	—
Pavilion III 54' x 36'	1944	19'	47	48	38	123	200	84	189	—	150	—
Prefunction 148' x 22'	3256	22'	—	—	—	—	—	—	330	—	—	—
Executive Boardroom 47' x 23'	1081	12'	30	35	30	50	100	48	116	—	80	—
Boardroom I 23' x 23'	529	12'	14	16	17	25	50	24	58	—	40	—
Boardroom II 24' x 23'	552	12'	14	16	17	25	50	24	58	—	40	—
Business Center 8' x 8'	64	12'	—	—	—	—	—	—	—	—	—	—
Private Office 6' x 8'	48	12'	—	—	—	—	—	—	—	—	—	—

dining | lodging | golf | tennis | spa | meetings | weddings



www.boarsheadinn.com

200 Ednam Drive | Charlottesville, VA 22903
 T. 800.476.1988 or 434.972.2224 | F. 434.972.6021
 E. meet@boarsheadinn.com

HISTORIC HOTELS
 of AMERICA
NATIONAL TRUST FOR HISTORIC PRESERVATION



Property Map

(Featured floorplans in red)

1. Main Inn Meeting Areas
 - a. Upper Meeting Rooms
 - b. Ballroom
2. Main Inn Meeting Areas
Ground Level Meeting Rooms
3. Tack Room
4. Coach Room
5. Ednam Hall Meeting Areas
 - a. Ednam Hall
 - b. Special Purpose Suite
6. Pavilion Meeting Areas
7. Spa
8. Sports Club
9. Golf Course

1a The Main Inn Meeting Areas UPPER MEETING ROOMS

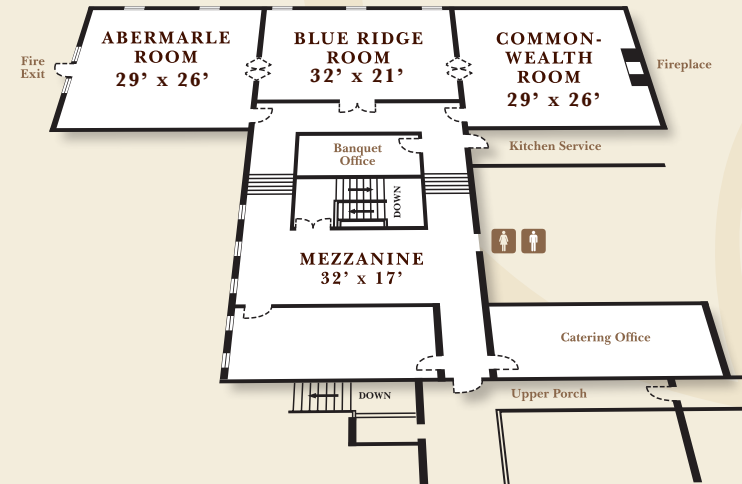

1b The Main Inn Meeting Areas

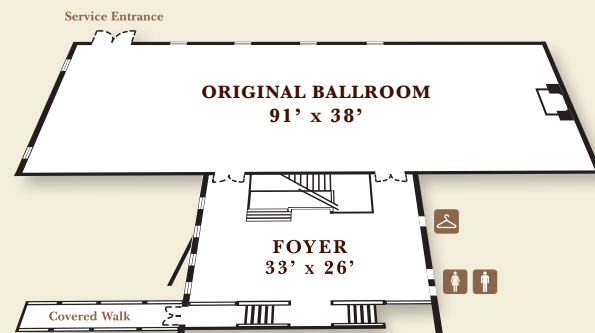

2 The Main Inn Meeting Areas GROUND LEVEL MEETING ROOMS

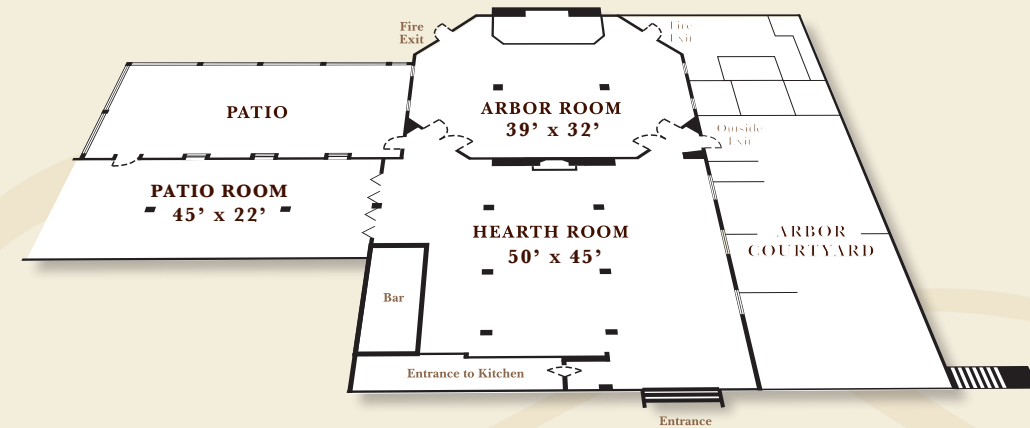

3 Tack Room

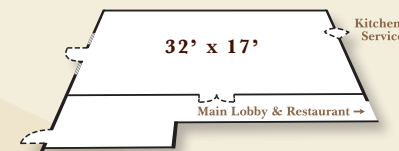

5a Ednam Hall

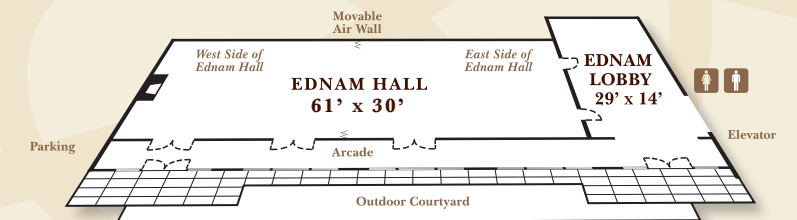

4 Coach Room

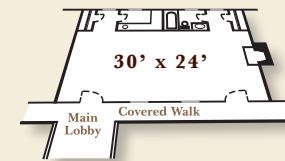

5b Special Purpose Suite 24' x 13'

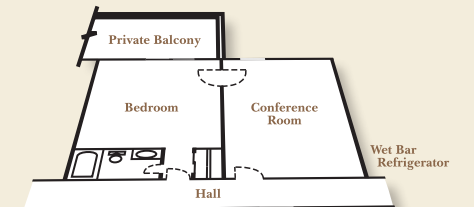

6 Pavilion Meeting Areas

